

# Micro Classroom/Meeting Room

**NOTE: The TV or projector MUST be set to HDMI! Regardless of your input connection type, the system in the wall always converts the output to HDMI.**

1. Turn on the Display
2. Connect your device to the white Extron DTP wall plate under the Display

## Display Types

Room	Display
TAC 206	Samsung UN75J6300 TV
TAC 208	Samsung UN75J6300 TV

### Samsung UN75J6300 TV Controls

Use the TV Control Stick (or Jog Stick) located on the rear right lower corner of the TV.

**Power On/Off** - Press the Control Stick in to turn the TV on. Press again to bring up the control menu and then move the stick select the Power icon and then press the stick to turn the TV off

You can adjust the volume by pressing the Control Stick.



Regardless of the Video source that you connect at the wall plate, the TV MUST BE SET TO HDMI1.

If you need to change the source, press the Control Stick to bring up the control menu which will appear in the lower right-hand corner of the screen. Select the Source Icon and then press the control stick.

Source options will appear across the top of the screen - move the control stick to HDMI1 and press the control stick to select.

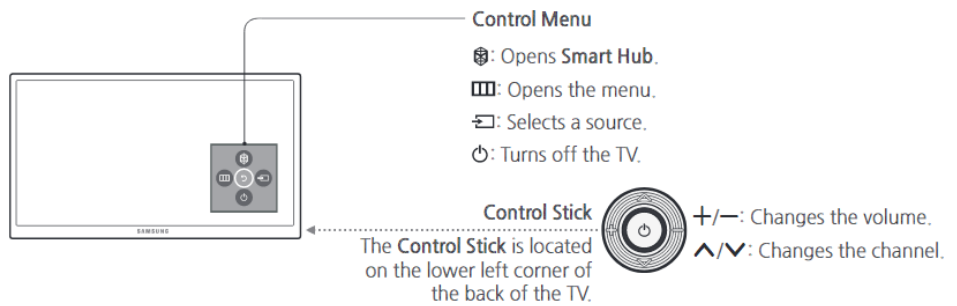

EXTRON DTP T UWP 4K 232 D

The wall plate located under the TV is and Extron DTP T UWP 4K 232 D.

Regardless of the input connection type, HDMI or VGA, the Extron DTP T UWP 4K 232 D, the output is always to HDMI so the display (TV or projector) will need to be set to HDMI.

